

Legend

-  Site Boundary
-  Proposed 2m high concrete post and timber hit and miss panel fence - (See Detail 01 on Dwg BD-01-PP)
-  Proposed 2m high wall, rendered blockwork finish to public side. Top of wall finished with a brick header course detail, fair faced blockwork to private side. Brick to match that used on the houses. (See Detail 02 Dwg BD-01-PP).
-  Proposed 1100mm Estate fencing to front of houses (See Detail 03 on Dwg BD-01-PP).
-  Proposed 1.6M high buff top railing (See Detail 05 on Dwg BD-02-PP).
-  Proposed gating opportunity to tie into 1.6M high buff top railing (See Detail 06 on Dwg BD-02-PP).

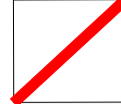

Rev.	Date	Note
00	0000-00-00	00

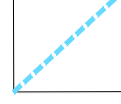
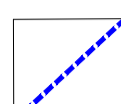
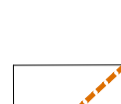
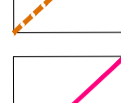
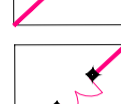
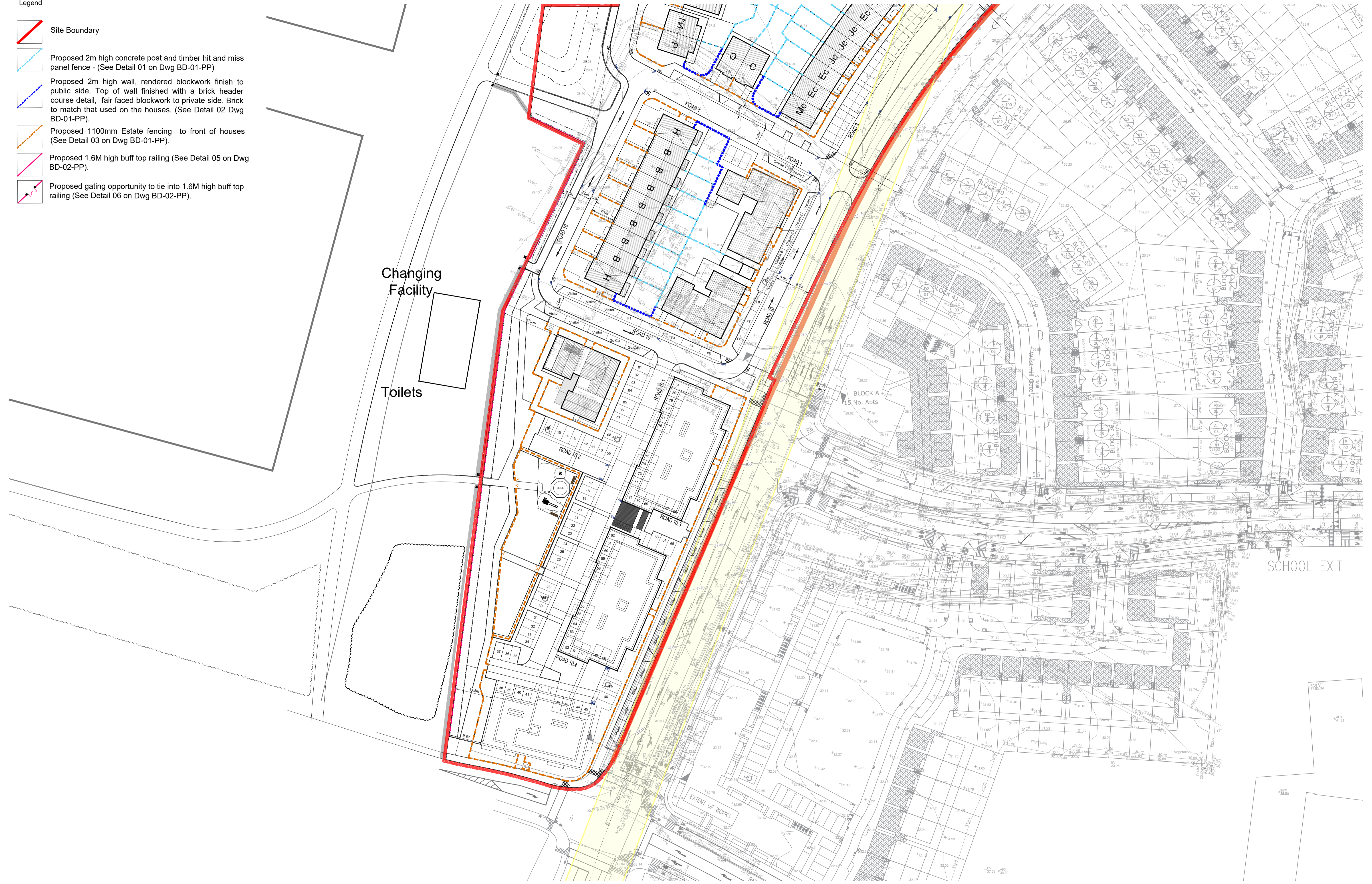
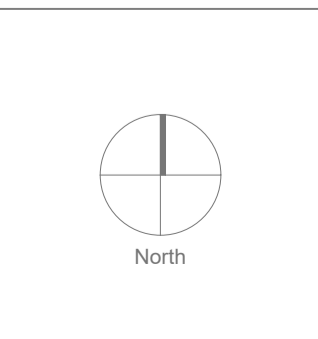

General Notes

Doyle & O'Troithigh
Landscape
Architecture

Project Name **Oldtown Phase 5** Drawing Name **Boundary Plan (3 of 3)**

Status	Planning	Drawing No	BP-04-PP
Project No	16-015	Revision No	00
Scale	1:500	Drawn By	A.D.
Date	23.03.2022	Checked By	D'OT

Links Doyle
Director
+353 (0)87 267 4198
links@doyle-otroithigh.com

Dathi O'Troithigh
Director
+353 (0)86 300 3488
dathi@doyle-otroithigh.com

Office Address
Pembroke House
26-28 Upper Pembroke St
Dublin 2

Contact
mail@doyle-otroithigh.com
+353 (0)1 608 7762